



FACT SHEET

City Parking Lot #21

Project Description: City Parking Lot #21 (formerly the Downtown Farmer's Market) was a stormwater retrofit project that included redesigning an existing half-acre asphalt parking lot into a more efficient and sustainable site. The project, located at the corner of West Washington and South Clinton Streets, featured the installation of an infiltration tree trench with structural soil, six native shade trees, porous pavers, and a subsurface infiltration system.

The non-porous areas of the redesigned parking lot were repaved with standard bituminous pavement and re-striped to create six additional parking spaces, including spaces for vehicles belonging to the plug-in hybrid non-profit community car-sharing program: CuseCar. The City Lot #21 project is designed to capture 1-inch of runoff from both the lot and adjacent pavement areas, resulting in a total annual capture of approximately 462,000 gallons of stormwater.

Project:	City Parking Lot #21
Project Owner:	Syracuse Urban Renewal Agency
GI Technology:	Bioretention & Infiltration trench
Project Location:	Corner of W. Washington St. & Clinton St.
Project Owner:	Onondaga County
Sewershed:	Clinton
Capture Area:	26,250 square feet
Run-off Reduction:	462,000 gallons/yr
Year Completed:	2010
Construction Cost:	\$188,046



Before



After

Version 8/5/2011

LEGEND	
	PERF. HDPE
	POROUS PAVERS
	MILL/NEW ASPHALT
	SOLID HDPE
	PARKING LOT STRIPING

- CONSTRUCTION NOTES:**
1. PROVIDE EROSION AND SEDIMENT CONTROL MEASURES WHERE AND WHEN APPROPRIATE AS PER THE NEW YORK STATE STANDARDS AND SPECIFICATIONS FOR EROSION AND SEDIMENT CONTROL (AUGUST 2008, OR LATEST EDITION), PROTECT EXISTING SITE FEATURES UNLESS OTHERWISE NOTED, CONSULT ENGINEER PRIOR TO INFILTRATION BED INSTALLATION.
 2. PROTECT INFILTRATION BED SUBGRADE FROM SEDIMENT DEPOSITION AND/OR COMPACTION DURING CONSTRUCTION, DO NOT ALLOW CONSTRUCTION VEHICLES TO TRAVEL ON THE INFILTRATION BED SUBGRADE.
 3. CONTRACTOR SHALL FOLLOW INFILTRATION BED AND DRAINAGE CONTROL REQUIREMENTS AS SPECIFIED BY ENGINEER.
 4. INSTALL STRUCTURAL SOL (20" WIDE, 9" DEEP) IN TREE TRENCH UNDER PAVERS AND ASPHALT. BASE BED TO INCLUDE ONLY CU STRUCTURAL SOL. #8 ALTERNATES TO INCLUDE SELVA CELL BY DEEP ROOT (WITH NATURAL SANDY LOAM) OR AS RECOMMENDED BY DEEP ROOT OR APPROVED EQUAL. LAND SAND-BASED STRUCTURAL SOL AS SHOWN ON SHEET CS.
 5. NOTIFY DGS SAFELY NEW YORK AT LEAST 72 HOURS PRIOR TO CONSTRUCTION.
 6. INSTALL TWO-RECE HDPE ANTI-SKEEP COLLAR BY LANE ENTERPRISES, OR APPROVED EQUAL. INSTALL COLLAR ON THE INDICATED SOLID HDPE PERIS APPROXIMATELY 1' FROM EDGE OF THE INFILTRATION BED/TREE TRENCH.
 7. ROOT BARRIER SHALL BE BY DEEP ROOT, OR APPROVED EQUAL, AND EXTEND FULL WIDTH AND DEPTH OF STRUCTURAL SOL, TO BE BED AS AN AD ALTERNATE.
 8. REFER TO DETAILS AND PROFILES ON SHEETS C06S.
 9. CLEANOUTS SHALL BE 6" PVC AS INDICATED ON DETAIL C06A.
 10. INSTALL EDGE BRACKET BETWEEN PAVERS AND ADJACENT ASPHALT PAVEMENT (ASPHALT EDGE BY PERMALOC, OR APPROVED EQUAL).
 11. INSTALL FLOGARD® (OR APPROVED EQUAL) FILTER INSERTS IN THE INDICATED CATCH BASINS (2).
 12. PLACE CATCH BASINS WITH OPEN GRATES IN THE MIDDLE OF THE POROUS PAVEMENT STRIP. THERE SHOULD BE APPROXIMATELY 18" OF PAVERS ON EITHER SIDE OF CATCH BASIN.
 13. IMMEDIATELY FOLLOWING CONSTRUCTION, RETURN ALL EXISTING IMPROVEMENTS TO PRE-CONSTRUCTION CONDITIONS.
 14. REUSE EXISTING HANDICAPPED PARKING SPACES WHERE SHOWN.
 15. FOR TREE SPECIES AND PLANTING INFORMATION, SEE SHEET C04. INSTALL TREES AS PER CITY STANDARDS.
 16. BOLLARDS SHALL BE PLACED AT THE FOUR CORNERS OF THE POROUS PAVERS. THEY SHALL BE REMOVABLE, PADLOCKABLE, AND FAUX WOOD FINISH-COLORED PLASTIC, UNLESS OTHERWISE APPROVED BY ENGINEER.

NOTE: IT IS A VIOLATION OF THE NEW YORK STATE EDUCATION LAW FOR ANY PERSON TO ALTER THIS DOCUMENT IN ANY WAY, UNLESS ACTING UNDER THE DIRECTION OF A LICENSED PROFESSIONAL ENGINEER. IF A DOCUMENT BEARING THE SEAL OF AN ENGINEER IS ALTERED, THE ALTERING ENGINEER SHALL AFFIX TO THE DOCUMENT THEIR SEAL, AND THE NOTATION "ALTERED BY" FOLLOWED BY THEIR SIGNATURE AND THE DATE OF SUCH ALTERATION, AND A SPECIFIC DESCRIPTION OF THE ALTERATION.

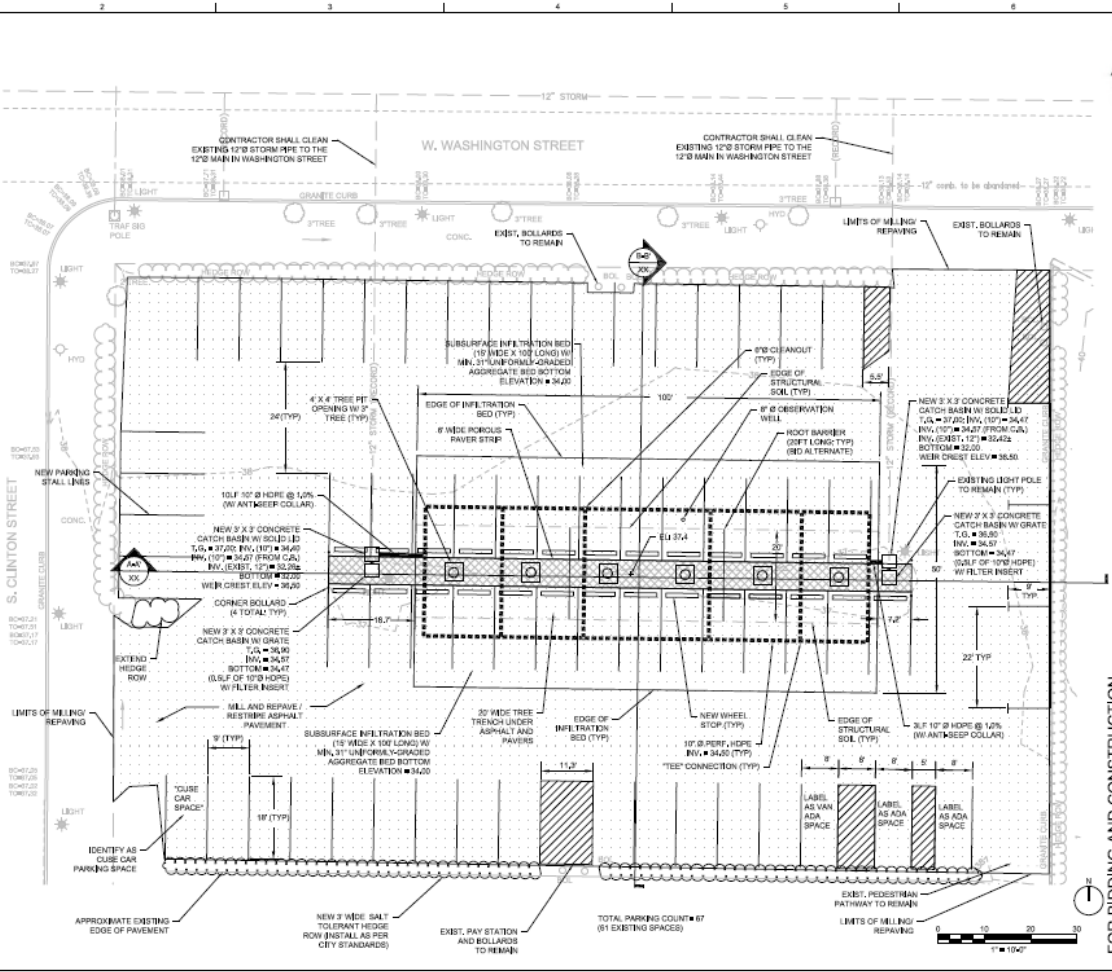

FOR BIDDING AND CONSTRUCTION

CH2MHILL

Civil
PARKING LOT LAYOUT PLAN

DATE	MARCH 22, 2010
PROJ.	381036
DRWG.	02
SHEET	2 OF 3

AS NOTED

DATE: MARCH 22, 2010
 PROJECT: 381036
 DRAWING: 02
 SHEET: 2 OF 3

Project plans for green infrastructure implementation at City Parking Lot #21

